



Southern Lehigh School District Hopewell Elementary School

Phase 1: New Building Construction

COMPLETE!



Remaining Work for All Primes: Final Systems Commissioning, Miscellaneous Equipment Adjustments, and Completion of Punch List Items

- GC – Lobar: Touch-up spackle, paint, and misc. finishes for punch list completion
- PC – DeWalt: Complete except for submission of Operations & Maintenance manuals
- MC – JBM: Heat pump service clearance adjustments, equipment commissioning with Air Balancing Engineers, program/graphics tweaks, owner training
- EC – Albarell: Card access system activation, final electrical inspection on solar array, classroom media system adjustments, owner training for lighting controls and sound systems

DEI is confirming the completion of punch list items, which are still in progress. Lobar had indicated work would be complete by Friday, September 23rd however punch list corrections will continue this week. Contractors have been reminded of urgency needed to complete!

**Phase 2: Existing Building Demolition
and Completion of Main Parking Lot (Milestone Completion Date 10/1/16)**

**Phase 3: Completion of Bowood Intersection (November 11, 2016)
and Final Site Work (by June 15, 2017)**

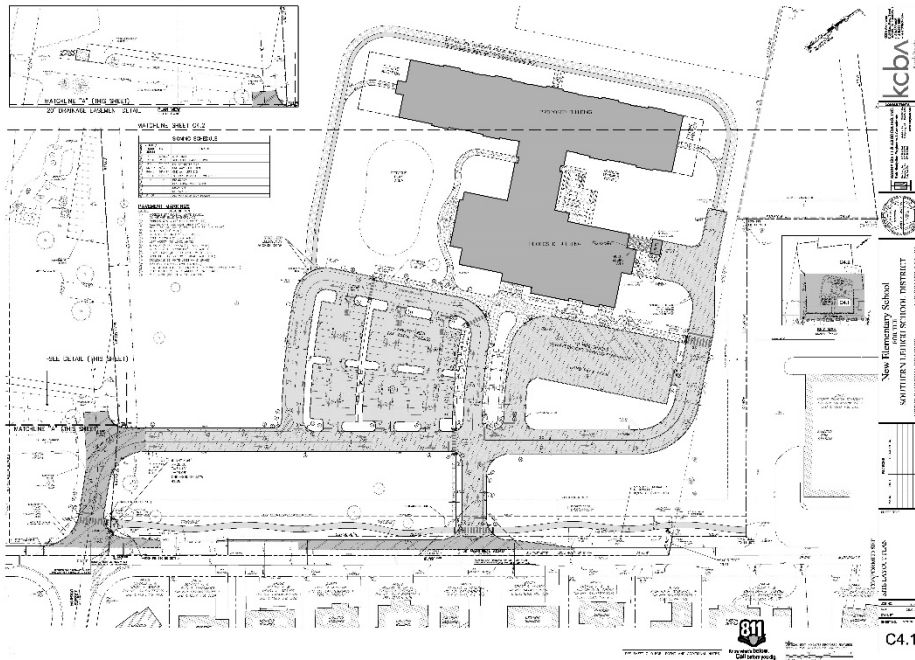

- ***District staff have done a tremendous job monitoring student drop-off & pick-up traffic***
- Removal of rubble from demolished building to be complete 9/27/16
- Parking lot curbing is complete. Parking lot stone base to be placed 9/27 – 9/29
- Base course of asphalt paving to be placed by October 7th
- Final “wearing” course of paving to be placed weekend of Oct. 7th – 10th

Contractor	Original Contract Amount	Change Orders to Date	Updated Contract Amount	Amount Paid to Date	Amount Remaining
Lobar (GC)	\$ 10,448,500.00	\$ -	\$ 10,448,500.00	\$ 9,312,844.12	\$ 1,135,655.88
JBM (MC)	\$ 2,630,000.00	\$ 395,241.00	\$ 3,025,241.00	\$ 2,661,713.03	\$ 363,527.97
Albarell (EC)	\$ 2,013,538.00	\$ -	\$ 2,013,538.00	\$ 1,746,592.33	\$ 266,945.67
DeWalt (PC)	\$ 835,000.00	\$ -	\$ 835,000.00	\$ 784,183.02	\$ 50,816.98
Sargent (EAC)	\$ 86,988.00	\$ (5,900.00)	\$ 81,088.00	\$ 69,565.10	\$ 11,522.90
Air Balancing Engineers	\$ 62,150.00	\$ -	\$ 62,150.00	\$ 7,956.00	\$ 54,194.00
Chrin	\$ 75,000.00	\$ -	\$ 75,000.00	\$ 24,175.39	\$ 50,824.61
Advantage - constr. testing	\$ 75,000.00	\$ -	\$ 75,000.00	\$ 28,128.88	\$ 46,871.12
Total	\$ 16,226,176.00	\$ 389,341.00	\$ 16,615,517.00	\$ 14,635,157.87	\$ 1,980,359.13

Contractor	Starting Allowance	Allowance Issued	Allowance Remaining
Lobar (GC)	\$ 172,350.00	\$ 95,839.70	\$ 76,510.30
JBM (MC)	\$ 121,000.00	\$ 65,957.56	\$ 55,042.44
Albarell (EC)	\$ 102,979.00	\$ 67,937.14	\$ 35,041.86
DeWalt (PC)	\$ 40,125.00	\$ 40,125.00	\$ -
Sargent (EAC)	\$ 5,900.00	\$ 5,900.00	\$ -
Total	\$ 442,354.00	\$ 275,759.40	\$ 166,594.60

Proposal Requests

Lobar	
Added metal work at dormers	\$ 2,039.85
Mechanical room exit devices	\$ 2,628.14
Terrazzo overtime	\$ 4,076.59
Door closer hold open arms	\$ 3,873.17
Install GWB and paint at theatrical lighting pocket	\$ 2,244.15
Install temporary stone walkway for teacher access to Area B	\$ 1,067.08
Provide stainless steel jamb at dishwasher pass-thru opening	\$ 909.23
Install silt soxx at 12 inlets to open infiltration bed	\$ 1,444.79
Re-construct bus parking area curb	\$ 5,000.00
Total:	\$ 23,283.00

Albarell	
Premium labor time; weekend work	\$ 8,752.62
Miscellaneous additional work in the kitchen	\$ 2,339.52
Add speaker in nurse suite	\$ 1,176.00
Add receptacles for copiers in Area B	\$ 1,131.00
Total:	\$ 13,399.14

DeWalt	
Concealed sprinkler head covers at media center wood	\$ 649.73
Provide 4" and 6" bird screens on overflow piping	\$ 186.60
Miscellaneous additional work in the kitchen	\$ 1,187.86
Total:	\$ 2,024.19

JBM	
Provide sheet metal shroud over switchgear	\$ 2,267.64
Total:	\$ 2,267.64

